

CASE STUDY

CUSTOMER CONVERTS ENTIRE FLEET TO BIRRANA™ COLLETED PINS

H-E PARTS INTERNATIONAL (H-E PARTS) PROVIDES SOLUTIONS FOR THE ENTIRE POWERTRAIN, SPECIALIZES IN THE RE-MANUFACTURE OF MAJOR MOBILE EQUIPMENT COMPONENTS, AND OFFERS INDUSTRY LEADING BIRRANA™ PRODUCTS. THE ENHANCED DESIGN FEATURES OF THE BIRRANA™ PRODUCTS DELIVER EXTENDED LIFE, EASE OF MAINTENANCE, AND SUPERIOR PERFORMANCE.

PROBLEM

A major mine owner in the Bowen Basin was experiencing issues with the OEM supplied strut pins used across their fleet. The OEM supplied pins were seizing into the chassis and spherical bearings of the suspension cylinders. Subsequent removal required thermal lancing to extract the pins. Thermal lancing and boring seized pins present increased safety risks, maintenance costs and result in extended downtime. Minimising downtime is a major consideration for owners of mobile mining equipment.

SOLUTION

The customer had been using the Birrana™ colleted pins on and off in conjunction with the traditional OEM pins and were impressed with the extended life and ease of installation and extraction the Birrana™ pins offered over the OEM. As the Birrana™ pins do not require lancing for removal, there is a significant downtime and risk reduction due to not needing to remove the rear wheels. Additionally, after lancing seized OEM pins, the bores of the chassis require reclamation for corrosion damage. This is not required when utilizing the Birrana™ colleted pins as they are corrosion resistant, easy to install and remove, maintenance free, reusable, and overall safer than traditional pins. The customer has now made a directive to converted their entire fleet to Birrana™ colleted pins.

RESULTS

Since implementing Birrana™ colleted pins, the customer has quoted downtime savings of at least 12 hours per suspension cylinder change and an improvement in safety due to not having to remove tyres or perform thermal lancing to remove seized pins.

LOCATION	Queensland, Australia.
APPLICATION	Komatsu 930E
PRODUCT	Birrana™ Colleted Pins

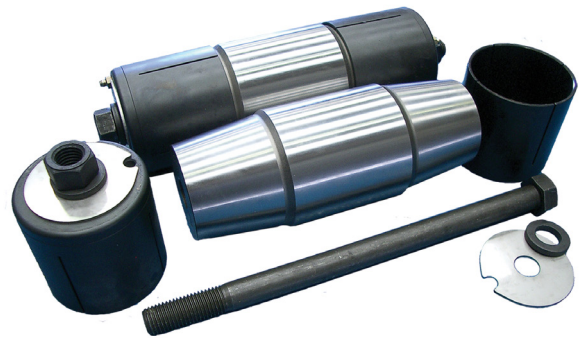

H-E Parts International replacement parts are compatible with the makes and/or models of the third-party equipment described. H-E Parts International is not an authorized repair facility of these third parties and it does not have an affiliation with any manufacturers of these third-party products. All brands, original equipment manufacturer (OEM) part numbers or references are owned by the respective OEM entities or their affiliates. These terms are used by H-E Parts International for identification and cross reference purposes only and are not intended to indicate affiliation with, or approval by the OEM, of H-E Parts International or its products. All parts are manufactured by, for and warranted by H-E Parts International and are not manufactured by, purchased from or warranted by the OEM.